



ecoFIT installation fitting type 310
For socket systems metric

Range of use:

- Compatible Signet flow sensors: type 2551, 2537, 515, 8510, 2536, 8512
- Compatible Signet pH/ORP sensors: type 2724, 2725, 2726, 2734, 2736, 2735

Attention:

- sensor length depends on installation fitting

Model:

- Material: PP-H/PE80
- Threaded outlet 1 ¼" NPSM
- Union end with fusion socket PE80
- Body and union nut PP-H

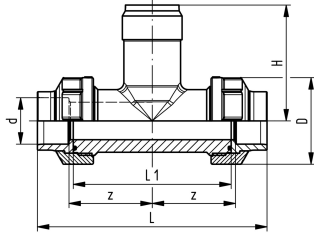

d (mm)	DN (mm)	EPDM Code	FKM Code	Weight (kg)	D (mm)	z (mm)	L (mm)	L1 (mm)	H (mm)	Sensor Type
20	15	733 310 006	733 310 036	0.136	48	50	128	90	76	flow X0, pH XX
25	20	733 310 007	733 310 037	0.190	58	55	421	100	78	flow X0, pH XX
32	25	733 310 008	733 310 038	0.250	65	60	156	110	81	flow X0, pH XX
40	32	733 310 009	733 310 039	0.356	79	60	160	110	85	flow X0, pH XX
50	40	733 310 010	733 310 040	0.510	91	65	176	120	89	flow X0, pH XX
63	50	733 310 011	733 310 041	0.800	105	70	194	130	95	flow X0, pH XX

The technical data are not binding. They neither constitute expressly warranted characteristics nor guaranteed properties nor a guaranteed durability. They are subject to modification. Our General Terms of Sale apply.

Georg Fischer Piping Systems Ltd, Postfach, CH-8201 Schaffhausen/Switzerland

Phone +41 -(0)52-631 1111

e-mail: info.ps@georgfischer.com

Internet: <http://www.gfps.com>