

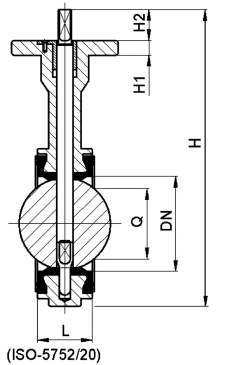

Bare shaft metal - butterfly valve type 039
Metric/Inch/ASTM

Model:

- Body GGG40 (A 395 / A395 M-99, EN-JIS 1020 EN1563) Rilsan® coating
- Seat material: EPDM, FKM and others on request
- Single-piece axis with square profile, up to DN 600 mm 2-pieces axis
- Installation length: EN 558 row 20
- Mounting between ISO, ANSI, BS or JIS Flanges
- Interface according to DIN EN ISO 5211



DN 50-300

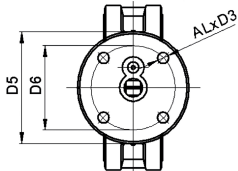
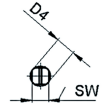

d (mm)	Size (inch)	DN (mm)	PN (bar)	kv-value ($\Delta p=1$ bar) (L/min)	Disc: ductile iron/Rilsan® coated EPDM Code	SP Weight (kg)	Disc: stainless steel EPDM Code	SP Weight (kg)
63	2	50	16	3140	198 152 100	1 3.300	198 152 120	1 3.300
75	2 ½	65	16	4570	198 152 101	1 4.000	198 152 121	1 4.000
90	3	80	16	7140	198 152 102	1 4.300	198 152 122	1 4.300
110	4	100	16	11710	198 152 103	1 5.700	198 152 123	1 5.700
140	5	125	16	18570	198 152 104	1 7.400	198 152 124	1 7.400
160	6	150	16	27130	198 152 105	1 8.900	198 152 125	1 8.900
225	8	200	16	47130	198 152 106	1 13.500	198 152 126	1 13.500
280	10	250	16	77110	198 152 107	1 22.800	198 152 127	1 22.800
315	12	300	16	114240	198 152 108	1 31.700	198 152 128	1 31.700

d (mm)	Disc: Alu- bronze EPDM Code	SP Weight (kg)
63	198 152 140	1 3.300
75	198 152 141	1 4.000
90	198 152 142	1 4.300
110	198 152 143	1 5.700
140	198 152 144	1 7.400
160	198 152 145	1 8.900
225	198 152 146	1 13.500
280	198 152 147	1 22.800
315	198 152 148	1 31.700

d (mm)	D3 (mm)	D4 (mm)	D5 (mm)	H (mm)	H1 (mm)	H2 (mm)	L (mm)	Cv val- ue ($\Delta p=1$ psi) (L/min)	Q (mm)	AL (mm)	D6 (mm)	SW (mm)	
63	9	14	90	221	13	26	43	220	32	F-07	4	70	11
75	9	14	90	243	13	26	46	320	51	F-07	4	70	11
90	9	14	90	258	13	26	46	500	69	F-07	4	70	11
110	9	18	90	295	16	30	52	820	89	F-07	4	70	14
140	9	18	90	323	16	30	56	1300	115	F-07	4	70	14
160	9	22	90	354	17	33	56	1900	143	F-07	4	70	17
225	9	22	90	427	17	33	60	3330	194	F-07	4	70	17
280	11	28	125	522	17	47	68	5400	243	F-10	4	102	22
315	11	28	125	589	17	47	78	8000	293	F-10	4	102	22

The technical data are not binding. They neither constitute expressly warranted characteristics nor guaranteed properties nor a guaranteed durability. They are subject to modification. Our General Terms of Sale apply.

Data sheet

valid from: 10/23/20



Georg Fischer Piping Systems Ltd, Postfach, CH-8201 Schaffhausen/Switzerland

Phone +41 -(0)52-631 1111

e-mail: info.ps@georgfischer.com

Internet: <http://www.gfps.com>