

Data sheet

valid from: 9/9/21

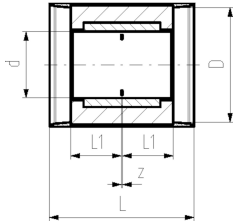

COOL-FIT 2.0 Coupler

Model:

- Pre-insulated PE100 SDR11, metric
- Insulation made from GF HE foam
- Impact resistant. Color: black
- Integrated sealing lip, for a moisture-proof and vapour tight sealing

Note:

bigger dimensions available via COOL-FIT 4.0 product range

d/D (mm)	SDR	PN (bar)	DN (mm)	Code	Weight (kg)	L (mm)	L1 (mm)	z (mm)	closest inch (inch)
32/75	11	16	25	738 914 108	0.092	113	36	5	1
40/90	11	16	32	738 914 109	0.126	121	40	3	1 ¼
50/90	11	16	40	738 914 110	0.160	129	44	3	1 ½
63/110	11	16	50	738 914 111	0.237	137	48	3	2
75/125	11	16	65	738 914 112	0.339	152	55	3	2 ½
90/140	11	16	80	738 914 113	0.476	166	62	4	3
110/160	11	16	100	738 914 114	0.778	188	72	4	4
140/200	11	16	125	738 914 116	1.097	210	84	3	5

The technical data are not binding. They neither constitute expressly warranted characteristics nor guaranteed properties nor a guaranteed durability. They are subject to modification. Our General Terms of Sale apply.

Georg Fischer Piping Systems Ltd, Postfach, CH-8201 Schaffhausen/Switzerland

Phone +41 -(0)52-631 1111

e-mail: info.ps@georgfischer.com

Internet: <http://www.gfps.com>