

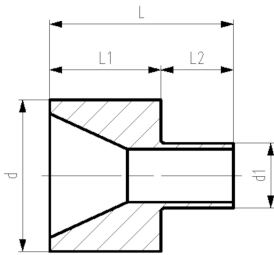

COOL-FIT 2.0 Reducer short

Model:

- Spigot fitting PE100 SDR11, metric with free end
- Space-optimized branch: sealing lip of Fitting Typ A that joins to the branch, needs to be cut and adhesive ring be use



d (mm)	d1 (mm)	d/D (mm)	d/D SDR (mm)	d1/D1 (mm)	PN (bar)	DN (mm)	Code	L (mm)	L1 (mm)	L2 (mm)
40	32	40/90	11	32/75	16	32	738 900 506	76	40	36
50	32	50/90	11	32/75	16	40	738 900 509	80	44	36
50	40	50/90	11	40/90	16	40	738 900 510	84	44	40
63	32	63/110	11	32/75	16	50	738 900 512	84	48	36
63	40	63/110	11	40/90	16	50	738 900 513	88	48	40
63	50	63/110	11	50/90	16	50	738 900 514	92	48	44
75	32	75/140	11	32/110	16	65	738 900 515	91	55	36
90	32	90/160	11	32/140	16	80	738 900 519	98	62	36
110	32	110/200	11	32/160	16	100	738 900 524	108	72	36

The technical data are not binding. They neither constitute expressly warranted characteristics nor guaranteed properties nor a guaranteed durability. They are subject to modification. Our General Terms of Sale apply.

Georg Fischer Piping Systems Ltd, Postfach, CH-8201 Schaffhausen/Switzerland

Phone +41 -(0)52-631 1111

e-mail: info.ps@georgfischer.com

Internet: <http://www.gfps.com>