

COOL-FIT 2.0 Flexible hose

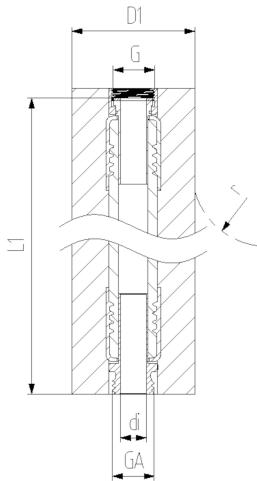

Model:

- EPDM flexible hose with stainless steel protection
- Brass adaptors
- Pre-Insulation made from NBR foam with outer jacket impact resistant and tearproof
- With loose union nut G on one end and male thread GA on the other



d (mm)	DN (mm)	Thread Type	Size (inch)	Size (inch)	Inch (inch)	G/GA (inch)	PN (bar)	Code	L1 (mm)	di (mm)	D1 (mm)	r (mm)
20	15	G/GA	½	1/2"	1/2"	1/2"	10	738 924 206	1000	15	39	119
25	20	G/GA		3/4"	3/4"	3/4"	10	738 924 207	1000	19	44	156
32	25	G/GA		1"	1"	1"	10	738 924 208	1000	25	51	192
40	32	G/GA		1 1/4"	1 1/4"	1 1/4"	8	738 924 209	1500	32	59	252
50	40	G/GA		1 1/2"	1 1/2"	1 1/2"	6	738 924 210	2000	38	69	312
63	50	G/GA		2"	2"	2"	6	738 924 211	2000	52	82	372

The technical data are not binding. They neither constitute expressly warranted characteristics nor guaranteed properties nor a guaranteed durability. They are subject to modification. Our General Terms of Sale apply.

Georg Fischer Piping Systems Ltd, Postfach, CH-8201 Schaffhausen/Switzerland

Phone +41 -(0)52-631 1111

e-mail: info.ps@georgfischer.com

Internet: <http://www.gfps.com>