

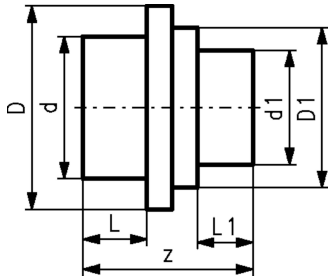

COOL-FIT 4.0 Reducer d250-d450

Model:

- Pre-insulated PE100 SDR 17 metric
- Insulation made from GF HE foam
- Outer jacket impact resistant. Color: black
- B: Spigot Fitting with free end (separate electrofusion fitting needed for joining)



| d/D (mm) | d1/D1 (mm) | SDR | DN (mm) | Code | Weight (kg) | L (mm) | L1 (mm) | z (mm) | Type |
|-------------|---------------|-----|------------|--------------------|----------------|-----------|------------|-----------|------|
| 250/355 | 225/315 | 17 | 250 | 738 903 825 | 2.800 | 123 | 110 | 332 | B |
| 280/400 | 225/315 | 17 | 250 | 738 903 829 | 4.700 | 126 | 110 | 335 | B |
| 280/400 | 250/355 | 17 | 250 | 738 903 830 | 5.100 | 133 | 110 | 365 | B |
| 315/450 | 225/315 | 17 | 300 | 738 903 836 | 7.100 | 126 | 110 | 340 | B |
| 315/450 | 250/355 | 17 | 300 | 738 903 837 | 7.400 | 133 | 123 | 365 | B |
| 315/450 | 280/400 | 17 | 300 | 738 903 838 | 6.800 | 133 | 126 | 365 | B |
| 355/500 | 250/355 | 17 | 350 | 738 903 844 | 8.200 | 148 | 123 | 390 | B |
| 355/500 | 280/400 | 17 | 350 | 738 903 845 | 7.700 | 148 | 126 | 390 | B |
| 355/500 | 315/450 | 17 | 350 | 738 903 846 | 8.300 | 148 | 133 | 390 | B |
| 400/560 | 280/400 | 17 | 400 | 738 903 853 | 9.100 | 150 | 126 | 415 | B |
| 400/560 | 315/450 | 17 | 400 | 738 903 854 | 11.400 | 150 | 133 | 420 | B |
| 400/560 | 355/500 | 17 | 400 | 738 903 855 | 11.000 | 150 | 148 | 405 | B |
| 450/630 | 280/400 | 17 | 450 | 738 903 862 | 13.200 | 165 | 126 | 390 | B |
| 450/630 | 315/450 | 17 | 450 | 738 903 863 | 13.600 | 165 | 133 | 390 | B |
| 450/630 | 355/500 | 17 | 450 | 738 903 864 | 13.700 | 165 | 148 | 393 | B |
| 450/630 | 400/560 | 17 | 450 | 738 903 865 | 14.800 | 165 | 150 | 395 | B |

The technical data are not binding. They neither constitute expressly warranted characteristics nor guaranteed properties nor a guaranteed durability. They are subject to modification. Our General Terms of Sale apply.

Georg Fischer Piping Systems Ltd, Postfach, CH-8201 Schaffhausen/Switzerland

Phone +41 -(0)52-631 1111

e-mail: info.ps@georgfischer.com

Internet: <http://www.gfps.com>